



Solenoid Valve Connectors

Form A to M12 (MDC) Solenoid Valve Receptacles



Form A to M12 (MDC) Male Receptacle | EN175301-803 | IP65 Rating

# of Poles	Voltage	Circuitry	Housing Color	M12 (MDC) # of Poles	
				4 Pole	5 Pole
2 + Ground	250V AC/DC (Maximum)	None	Gray	VFN-029-3401	VFN-029-3501
			Black	VAN-029-3401	VAN-029-3501
	10-50V DC	LED w/ Flyback Diode	Clear	VAC-029-3401	VAC-029-3501
	24V AC/DC	LED w/ MOV	Clear	VAG-029-3401	VAG-029-3501
	120V AC/DC	LED w/ MOV	Clear	VAJ-029-3401	VAJ-029-3501
	120V AC/DC	Bridge Rectifier w/ LED & MOV	Clear	VAR-029-3401	VAR-029-3501

Two standard orientations are available. Please refer to the part number system shown above each drawing.

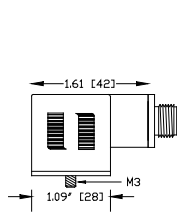

Vxx-029-3401

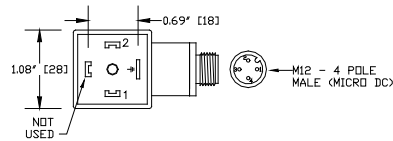

2 Poles + Ground
(Ground Receptacle Side)

Vxx-029-3501

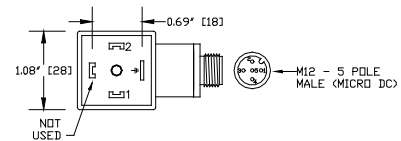

2 Poles + Ground
(Ground Receptacle Side)

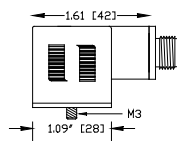

Vxx-089-3401

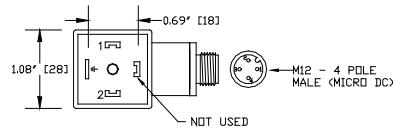

2 Poles + Ground
(Ground Opposite Receptacle Side)

Vxx-089-3501

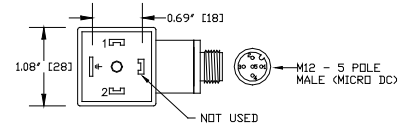

2 Poles + Ground
(Ground Opposite Receptacle Side)

DIN Connector Specifications:

- Body: Polyamide
- Contacts: Copper Alloy with Silver Plating
- Insert: Polyamide
- Gasket: Thermoplastic
- Screw: Zinc Plated Steel
- Cable O.D.: PG 7 - 6 to 7 mm
- Temperature: Gray & Black: -40°C to 125°C (-40°F to +257°F)
Clear: -25°C to 90°C (-13°F to 194°F)

MDC Connector Specifications:

- Coupling Nut: Nickel Plated Brass
- Insulator: Polyamide
- Contacts: Copper Alloy with Gold Plating
- O-Ring: BUNA-N
- Temperature: -40°C to 80°C (-40°F to +176°F)

Valve Connectors	M12 (MDC) 4 Pole PIN #	M12 (MDC) 5 Pole PIN #
1	4	4
2	3	3
Ground	N/A	5
3 Not Used	1, 2 & 5 Not Used	1 & 2 Not Used